

# It's a Wrench

Designed by Wendy Sheppard  
 Featuring Tool Time by Whistler Studios  
 SIZE: 74" x 87"



**THIS IS A DIGITAL REPRESENTATION OF THE QUILT TOP, FABRIC MAY VARY.**

**PLEASE NOTE:** BEFORE MAKING YOUR PROJECT, CHECK FOR ANY PATTERN UPDATES AT [WINDHAMFABRICS.COM](http://WINDHAMFABRICS.COM)'S FREE PROJECTS SECTION.



# It's a Wrench

KEY	FABRIC	SKU	YD	CUTTING INSTRUCTIONS
A		50280-2 White	1 3/8	(8) 5-1/2" x WOF strips. Piece strips and subcut (2) 5-1/2" x 74-1/2" and (2) 5-1/2" x 77-1/2" strips.
B		50284-7 Slate	3/8	(1) 5-1/2" x WOF strip. Subcut (2) 5-1/2" x 8-1/2", (3) 2" x 3-1/2" and (3) 1-1/2" x 4" pieces. (1) 3-1/2" x WOF strip. Subcut (4) 3-1/2" squares and (2) 3 1/2" x 12 1/2" pieces.
C		50282-3 Teal	3/4	(7) 3" x WOF strips. Piece strips and subcut (2) 3" x 62-1/2" and (2) 3" x 70-1/2" strips.
D		50283-1 Navy	3/8	(1) 5-1/2" x WOF strip. Subcut (2) 5-1/2" x 8-1/2", (3) 2" x 3-1/2" and (3) 1-1/2" x 3" pieces. (1) 3-1/2" x WOF strip. Subcut (4) 3-1/2" squares and (2) 3 1/2" x 12 1/2" pieces.
E		50283-5 Orange	1/8	(1) 2" x WOF strip. Subcut (6) 2" x 3-1/2" pieces. (1) 1-1/2" x WOF strip. Subcut (3) 1-1/2" x 3" and (3) 1-1/2" x 4" pieces.
F		50284-1 Navy	3/8	(1) 5-1/2" x WOF strip. Subcut (2) 5-1/2" x 8-1/2", (3) 2" x 3-1/2" and (3) 1-1/2" x 3" pieces. (1) 3-1/2" x WOF strip. Subcut (4) 3-1/2" squares and (2) 3 1/2" x 12 1/2" pieces.
G		50284-6 Yellow	1/8	(1) 2" x WOF strip. Subcut (9) 2" x 3-1/2" pieces. (1) 1-1/2" x WOF strip. Subcut (6) 1-1/2" x 3" and (3) 1-1/2" x 4" pieces.
H		50281-X Multi	3/8	(1) 5-1/2" x WOF strip. Subcut (2) 5-1/2" x 8-1/2" pieces. (1) 3-1/2" x WOF strip. Subcut (4) 3-1/2" squares and (2) 3 1/2" x 12 1/2" pieces.
I		50285-3 Teal	1/8	(1) 2" x WOF strip. Subcut (3) 2" x 3-1/2" pieces and (3) 1-1/2" x 3" pieces.
J		50285-5 Orange	1	(1) 5-1/2" x WOF strip. Subcut (2) 5-1/2" x 8-1/2", (3) 2" x 3-1/2" and (3) 1-1/2" x 3" pieces. (1) 3-1/2" x WOF strip. Subcut (4) 3-1/2" squares and (2) 3 1/2" x 12 1/2" pieces. (8) 2-1/4" x WOF strips for binding.





# It's a Wrench

<b>K</b>		50285-8 White	3 3/8	<p>(1) 8-1/2" x WOF strip. Subcut (24) 1-1/2" x 8-1/2" pieces.</p> <p>(1) 5" x WOF strip. Subcut (18) 1" x 5" pieces.</p> <p>(2) 4 1/2" x WOF strips. Subcut (18) 1-1/2" x 4-1/2" pieces and (54) 1" x 4-1/2" pieces.</p> <p>(9) 4" x WOF strips. Subcut (24) 4" x 12-1/2" pieces and (18) 1-1/2" x 4" pieces.</p> <p>(3) 2-1/2" x WOF strip. Subcut (12) 2-1/2" x 3-1/2" pieces and (24) 2-1/2" squares.</p> <p>(13) 3" x WOF strips. Subcut (24) 3" squares and (54) 1-1/2" x 3" pieces. Piece remaining (9) strips and subcut (2) 3" x 65-1/2" strips, (2) 3" x 57-1/2" strips, and (2) 3" x 52-1/2" strips.</p> <p>(7) 1-1/2" x WOF strips. Piece strips and subcut (2) 1-1/2" x 64-1/2" strips and (2) 1-1/2" x 75-1/2" strips.</p>
<b>L</b>		50286-4 Grey	3/8	<p>(1) 5-1/2" x WOF strip. Subcut (2) 5-1/2" x 8-1/2", (3) 2" x 3-1/2" and (3) 1-1/2" x 3" pieces.</p> <p>(1) 3-1/2" x WOF strip. Subcut (4) 3-1/2" squares and (2) 3 1/2" x 12 1/2" pieces.</p>
<b>M</b>		50286-7 Slate	1/8	<p>(1) 2" x WOF strip. Subcut (3) 2" x 3-1/2" and (3) 1-1/2" x 3" pieces.</p>
		Backing	5 1/4	
				80" x 93" piece of batting



# It's a Wrench

## Making the Blocks

1. Draw a diagonal line on the wrong side of (1)  $2\frac{1}{2}$ " **K** square. Place square, right sides together, at a corner of (1)  $3\frac{1}{2}$ " **B** square and sew on the drawn line. Trim  $\frac{1}{4}$ " away from sewn line. Open and press to reveal **K** corner triangle. In the same way, make a mirror image unit.

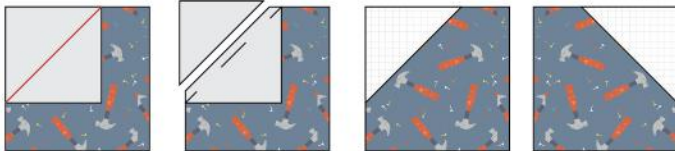

2. Sew both units from step 1 to the opposite long sides of (1)  $2\frac{1}{2}$ " x  $3\frac{1}{2}$ " **K** piece to make a wrench tip unit.



3. Draw a diagonal line on the wrong side of (1) 3" **K** square. Place square, right sides together, at a corner of (1)  $5\frac{1}{2}$ " x  $8\frac{1}{2}$ " **B** piece and sew on the drawn line. Trim  $\frac{1}{4}$ " away from sewn line. Open and press to reveal **K** corner triangle. Repeat on the adjoining corner as shown to make a wrench center unit.

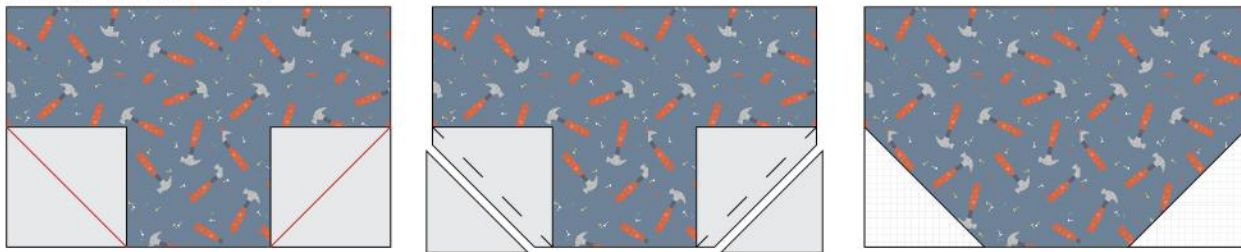

4. Sew together the wrench tip and center units as shown and add  $1\frac{1}{2}$ " x  $8\frac{1}{2}$ " **K** pieces to the sides. The wrench top unit should measure  $10\frac{1}{2}$ " x  $8\frac{1}{2}$ ".

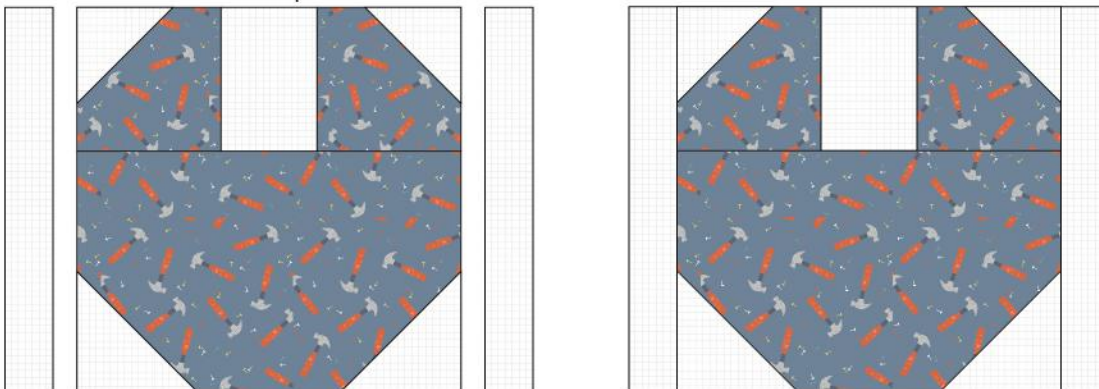



# It's a Wrench

5. Sew 4" x 12-1/2" **K** pieces to the opposite long sides of (1) 3 1/2" x 12 1/2" **B** piece. The wrench bottom unit should measure 10-1/2" x 12-1/2".

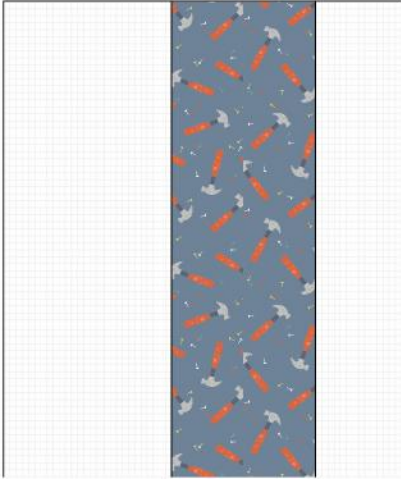

6. Sew a wrench top unit to a wrench bottom unit to make a 10-1/2" x 20-1/2" wrench block. In the same way, make a total of (2) blocks each using the following combinations: **B/K**, **D/K**, **F/K**, **H/K**, **J/K**, and **L/K**.

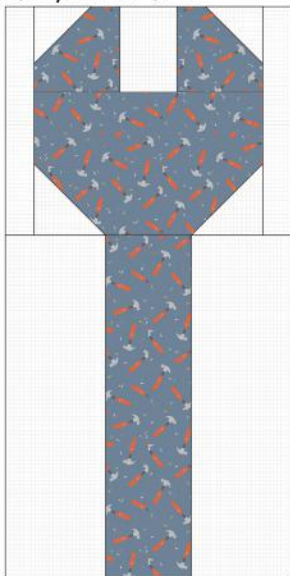

7. Short bolt units. Sew 1-1/2" x 3" **K** pieces to the opposite long sides of (1) 1-1/2" x 3" **D** piece. Add (1) 2-1/2" x 3-1/2" **D** piece to the top, followed by (2) 1" x 4 1/2" **K** pieces to the left and right sides. Add (1) 1-1/2" x 4-1/2" **K** piece to the bottom. Unit should measure 4-1/2" x 5-1/2". Make a total of (3) short bolt units each using the following combinations: **D/K**, **E/K**, **F/K**, **I/K**, **J/K**, **L/K** and **M/K**. Make a total of (6) short bolt units **G/K** fabrics.

(See image on next page)





# It's a Wrench

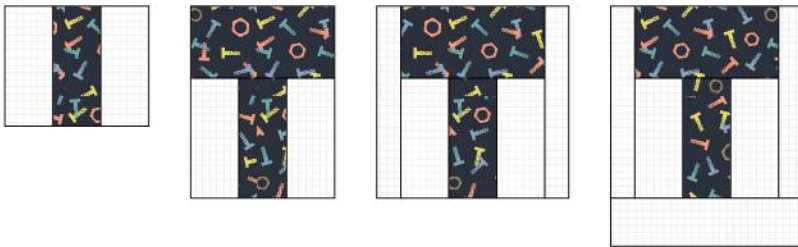

8. Long bolt units. Sew 1-1/2" x 4" **K** pieces to the opposite long sides of (1) 1-1/2" x 4" **G** piece. Add (1) 2-1/2" x 3-1/2" **B** piece to the top, followed by (2) 1" x 5" **K** pieces to the left and right sides. The unit should measure 4-1/2" x 5-1/2". Make a total of (3) long bolt units each using the following combinations: **E/K**, **G/K** and **H/K**.

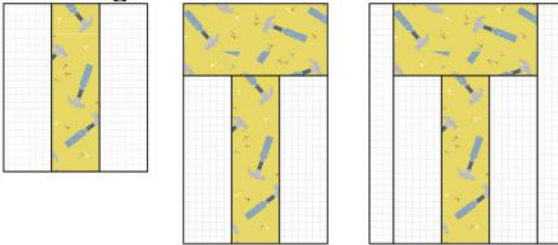

9. Sew together (3) short bolt units and (1) long bolt unit into a multi-bolt unit as shown. Make a total of (3) multi-bolt unit in each of the combinations shown below.

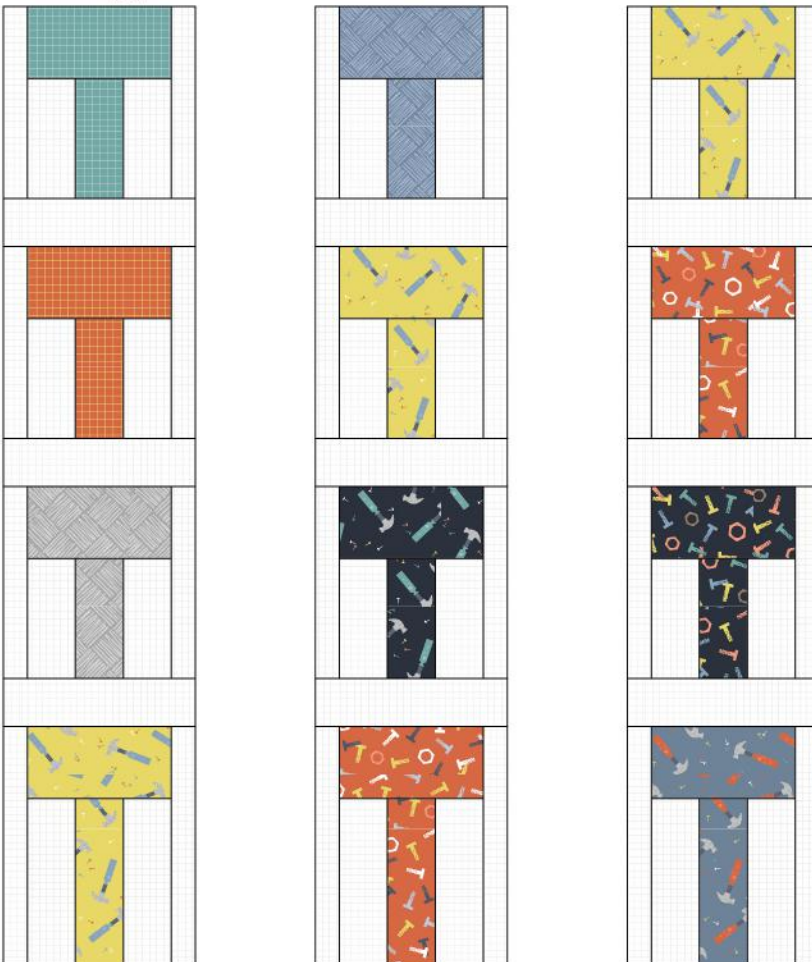



# It's a Wrench

## Assembly

10. Referring to the Quilt Assembly Diagram, lay out the (12) wrench blocks and (9) multi-bolt units into (3) rows. Join the blocks and units into rows.
11. Sew together the pieced rows alternating with (2) 3" x 52-1/2" **K** sashing strips to complete quilt center.
12. Inner border #1. Sew 3" x 65-1/2" **K** strips to the opposite long sides of quilt center. Sew 3" x 57-1/2" **K** strips to the top and bottom.
13. Inner border #2. Sew 3" x 70-1/2" **C** strips to the opposite long sides of quilt center. Sew 3" x 62-1/2" **C** strips to the top and bottom.
14. Inner border #3. Sew (2) 1-1/2" x 75-1/2" **K** strips to the opposite long sides of quilt center. Sew 1-1/2" x 64-1/2" **K** strips to the top and bottom.
15. Outer border. Sew 5-1/2" x 77-1/2" **A** strips to the opposite long sides of quilt center. Sew 5-1/2" x 74-1/2" **A** strips to the top and bottom.

## Finishing

16. With the backing fabric laying taut, layer batting and quilt top to form a quilt sandwich. Baste the sandwich and quilt as desired.
17. Use the (8) 2-1/4" x WOF **J** strips to bind the quilt.

*See Quilt Assembly Diagram on page 7.*





# It's a Wrench

